

Current part is item (12) on diagram. Available at www.oshkoshequipment.com

(1)	(2)	(3)	(4)	(5)	(6)				(7)			(8)			(9)	(10)	
SMR	FEDERAL	DESCRIPTION	UNIT	QTY	15-DAY ORGANIZATION				30-DAY DS			30-DAY GS			1-YR. ALW	ILLUSTRATION	
CODE	STOCK		OF	INC	MAINTENANCE				MAINTENANCE			MAINTENANCE			PER 100	(A)	(B)
	NUMBER		MEAS	IN	ALLOWANCE				ALLOWANCE			ALLOWANCE			EQUIP	(A)	(B)
		REFERENCE NUMBER & MFR CODE	USABLE ON CODE	UNIT	(A)	(B)	(C)	(D)	(A)	(B)	(C)	(A)	(B)	(C)	PLANNING	FIG	ITEM
					1-5	6-20	21-50	51-100	1-20	21-50	51-100	1-20	21-50	51-100		NO	NO
PAOZZ	5306-797-9338	BOLT, MACH, HEX HD: 7/8-14NF-3 X 101/4 7979338 (19207)		EA	24	*	*	*	*	*	*	*	*	*		37	4
PAOZZ	2510-734-6998	BRACKET ASSY: SPRING GUIDE 7979363 (19207)		EA	4	*	*	*	*	*	*	*	*	*		37	5
XAOZZ		BRACKET: SPRING GUIDE 7979364 (19207)		EA	4											37	6
PAOZZ	2510-734-6999	PLATE: SPRING GUIDE 7346999 (19207)		EA	4	*	*	*	*	*	*	*	*	*		37	7
XAOZZ		RIVET: 3/8 X 1 3/8, COUNTERSUNK HD MS357744-70 (96906)		EA	8											37	8
PAOZZ	2510-734-6952	PLATE, SPRING BRG 7979272 (19207)		EA	4	*	*	*	*	*	*	*	*	*		37	9
PAOZZ	5310-754-2005	WASHER, LOCK, SPLIT: 7/8 ID MS35338-52 (96906)		EA	24	*	*	*	*	*	*	*	*	*		37	10
PAOZZ	5310-734-6957	NUT, PLAIN, HEX: 7/8-14NF-3 7979327 (19207)		EA	24	*	*	*	*	*	*	*	*	*		37	11
PAOZZ	2530-797-9224	BRACKET: TORQUE ROD 7346955 (19207)		EA	6	*	*	*	*	*	*	*	*	*		37	12
PAOZZ	2530-797-9311	BRACKET: UPPER TORQUE ROD BRACKET MIG 7979311 (19207)		EA	2	*	*	*	*	*	*	*	*	*		37	13
PAOZZ	5310-842-7634	NUT, SLOTTED, HEX: 1 1/2-12NF-3 MS35692-109 (96906)		EA	12	*	*	*	*	*	*	*	*	*		37	14
PAOZZ	5315-187-9567	PIN, COTTER: 3/16 X 2 1/2 MS24665-500 (96906)		EA	12	*	*	*	*	*	*	*	*	*		37	15
		GROUP 18-BODY															
XBOZZ		1808-STOWAGE BOX BOX ASSY, STOWAGE 8730451 (19207)	D, E	EA	1											38	
XBOZZ		BOX, STOWAGE: WELDED 87304737 (19207)		EA	1											38	1
PAOZZ	5310-732-0558	NUT, PLAIN, HEX: 3/8-16 UNC-2B (DOOR MTG) MS51967-8 (96906)		EA	16	*	*	*	*	*	*	*	*	*		38	2
PAOZZ	5310-637-9541	WASHER, LOCK, SPLIT: 3/8 ID (DOOR MTG) MS35338-46 (96906)		EA	16	*	*	*	*	*	*	*	*	*		38	3
PAOZZ	5305-269-3211	SCREW, CAP, HEX HD: 3/8-16 UNC-2A X 1/8 (DOOR MTG) MS90725-60 (96906)		EA	16	*	*	*	*	*	*	*	*	*		38	4
PAOZZ	2510-177-7807	DOOR ASSY: W/SEALS 8730443 (19207)		EA	2	*	*	*	*	*	*	*	*	*		38	5
XAOZZ		SEAL: SYN RU, 101/8 X 3/4 X 1/2 8730449 (19207)		EA	4											38	6

Current part is item (12) on diagram. Available at www.oshkoshequipment.com

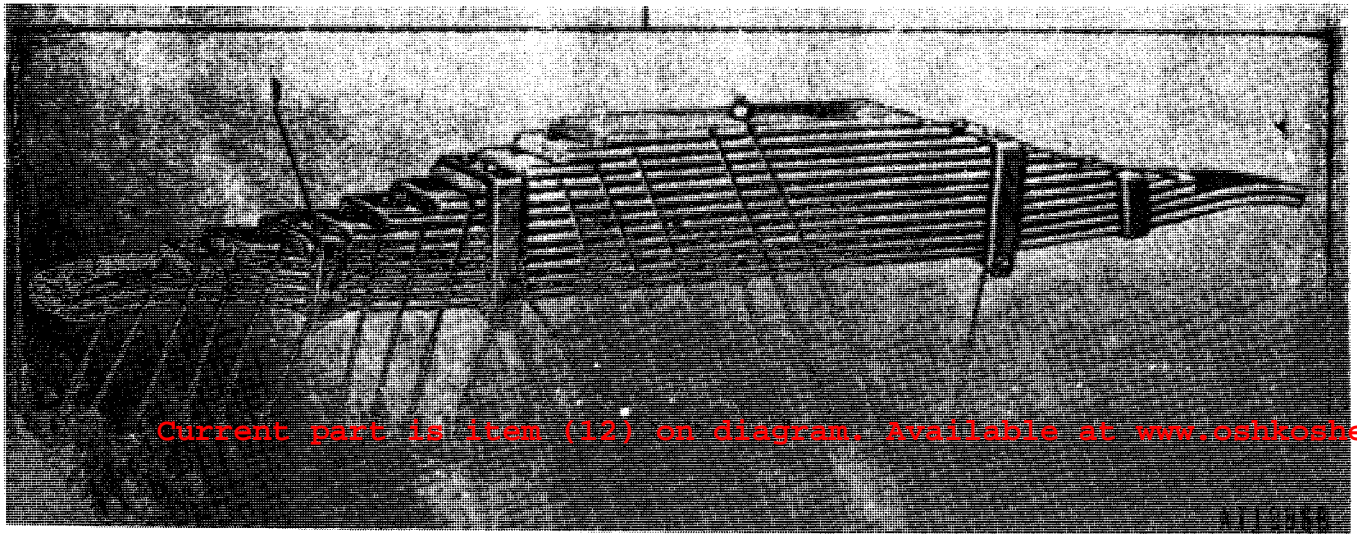

Current part is item (12) on diagram. Available at www.oshkoshequ.

Figure 36. Spring assembly (7979217)—assembled view.

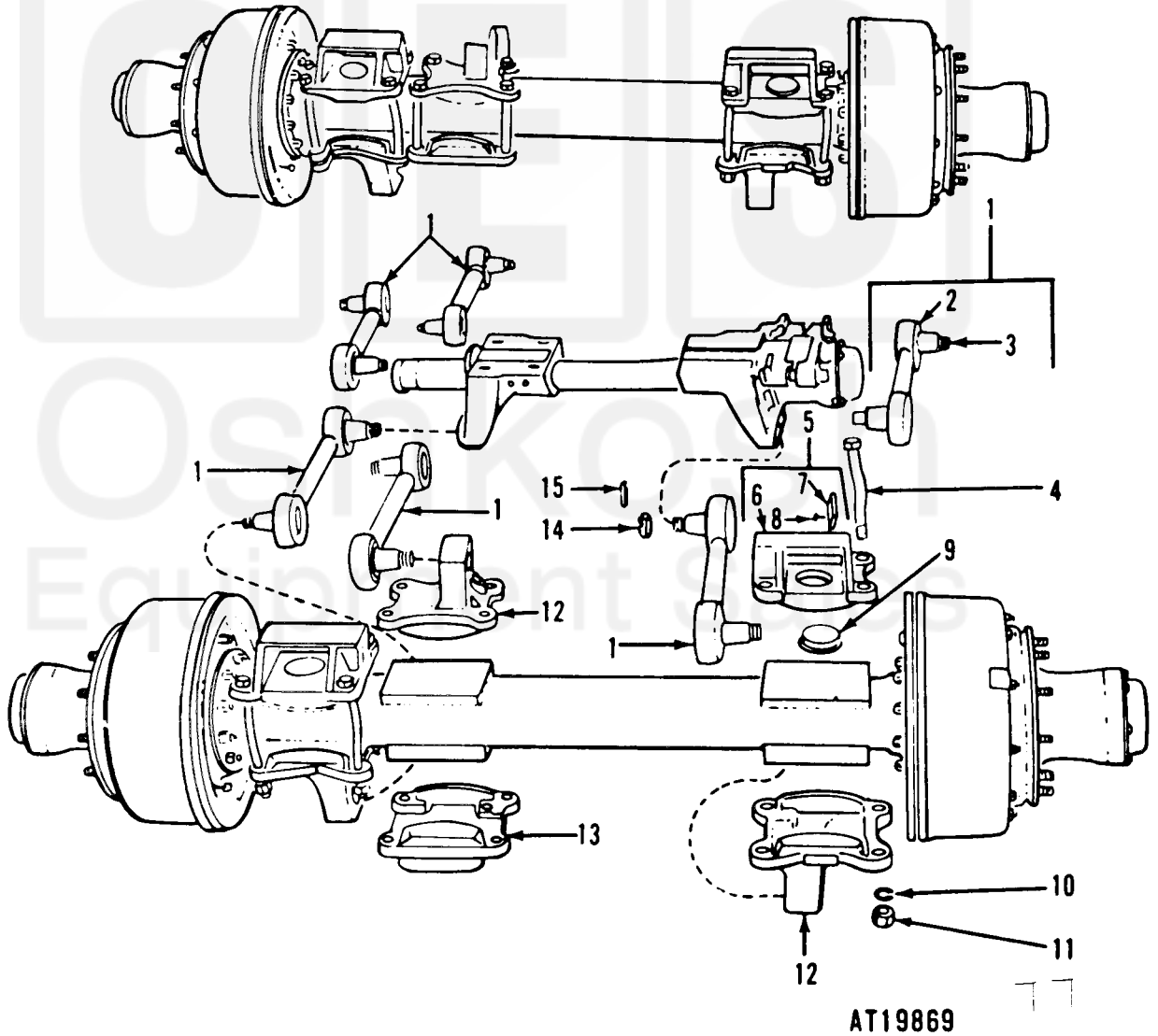

Figure 37. Torque rods, spring guide brackets, and attaching parts—exploded view.

Current part is item (12) on diagram. Available at www.oshkoshequ.